

# BEESTON TOWN CENTRE PLAN

## Consultation on 'Preferred Options' Let us have your views



Beeston is one of the most popular and vibrant town centres in Greater Nottingham. We want to make sure that it continues to prosper and becomes even more attractive. There needs to be appropriate provision to meet the growing demand for new shops and businesses. It will also be necessary to accommodate NET Phase 2, should the new tram scheme go ahead.

The council and other interested parties appointed consultants (Atkins Ltd) to prepare planning guidance for Beeston. Their vision for the future of the town is set out in their Beeston Town Centre - Preferred Options Report. It includes a 'strategic development framework' and proposals for developing specific sites.

We now want to know your views on the proposals. These can be made on the **Comments Form inside this leaflet** - which should be returned to the council offices after completing - or via the council's website. Please let us have your comments by 21st September 2007.

**Thank you for your time and interest.**



[www.broxtowe.gov.uk](http://www.broxtowe.gov.uk)

Follow the links through Planning, Planning Policy, and Local Development Framework to Beeston Town Centre



Although the study area is wider than the central area of Beeston, most of the proposals involving new building or major change to roads fall within the central area. This map shows the central area - the sites for proposals along Chilwell Road are shown on the back page. Please use the Comments Form to let us know your views.

## PROPOSALS FOR THE CENTRAL AREA

Designs of buildings are **illustrative** only and may not represent the final schemes

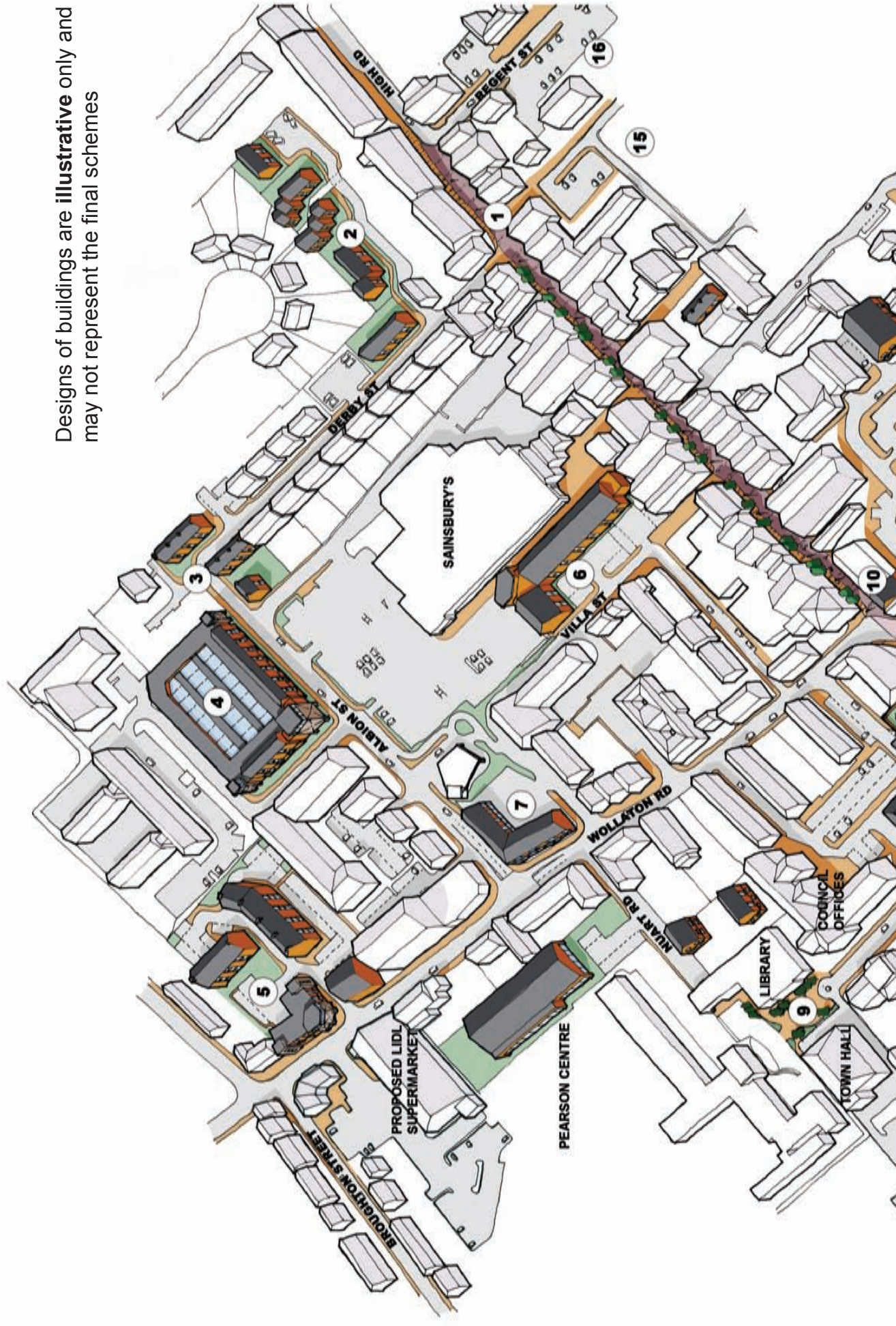





- |   |   |
|---|---|
| <ol style="list-style-type: none"> <li>1. Extend pedestrianised area of High Road as far as Regent Street Junction</li> <li>2. Proposed housing on Roberts Yard and Derby Street public car-park</li> <li>3. Proposed housing and road link between Albion Street and Derby Street</li> <li>4. Proposed multi-storey car-park with commercial/housing units</li> <li>5. Proposed retail/office/housing development</li> <li>6. Proposed retail/office/housing development</li> <li>7. Proposed retail/office/housing development Albion Street to become two-way throughout</li> <li>8. Proposed retail/housing development replacing part of Foster Avenue car park (access via a widened Commercial Avenue in line with NET's proposals for changes in access arrangements)</li> <li>9. Proposed public space in key civic area. Access to school car-park would be maintained</li> </ol> | <ol style="list-style-type: none"> <li>10. Proposed improvement or redevelopment of existing Clinton Cards building, High Road</li> <li>11. Proposed retail/housing development to replace The Square precinct</li> <li>12. Proposed retail/housing development to replace bus station, fire station and adjoining shops</li> <li>13. Proposed improved public space adjacent to tram stop and bus interchange</li> <li>14. Proposed market in the public space adjacent to the tram/bus interchange</li> <li>15. Proposed housing on City Road (south) car-park, City Road (north) car-park to be for Blue badge holders only</li> <li>16. Proposed parking area to replace Hofton's building yard, Regent Street</li> </ol> |
|---|---|



# Plan proposals not in the central area of Beeston

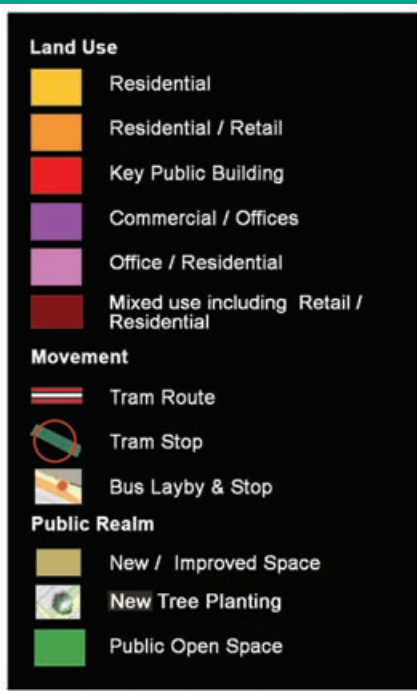

The map on this page shows part of the Chilwell Road area where there are redevelopment opportunities. It includes site reference numbers 17 and 18, and any comments on these should be made on the Comments Form.

17. Proposed retail, housing, office and other employment uses adjacent to proposed tram stop at Chilwell Road.
18. Proposed mixed use area at Chilwell Road covering former Barton's bus depot and west side of Holly Lane.



A display of the proposals will be available at Beeston Library and the borough council's offices at Foster Avenue, Beeston, during their normal opening hours. In addition the display will visit other venues to be advertised in the Beeston Express, and on the council's website.

Now please turn to the Comments Form inside to make your comments.  
Thank you